

ESP	MACHINE CODE	DESC.
9	B20039	P45C FNDF-70

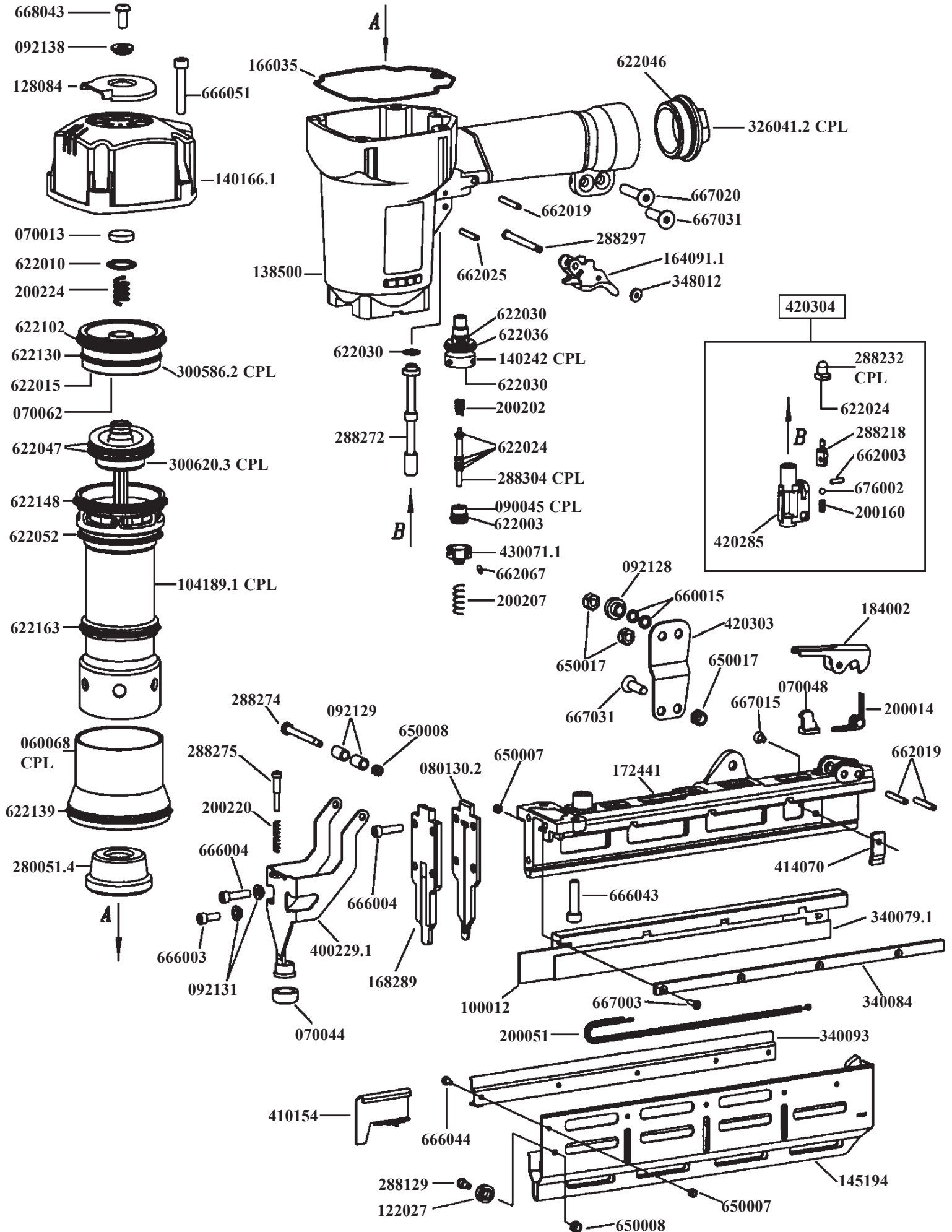

**MACHINE CODE**  
**B20039**

**MODEL**  
**P45C FNDF - 70**

**PARTS LIST**

CODE	QTY	DESCRIPTION	CODE	QTY	DESCRIPTION
060068	1	CYLINDER RING	400229.1	R 1	SAFETY
070013	R 1	BUFFER	410154	R 1	PUSHER FNDF
070044	R 1	BUFFER	414070	1	LOADER SQUARE
070048	R 1	BUFFER	420285	1	TRIGGER ACTUATOR
070062	R 1	BUFFER	420303	1	HOLDER
080130.2	1	DRIVER REST	420304	1	CPL SWITCH ACTUATOR SUPP
090045	1	CPL BUSH	430071.1	1	TRIGGER VALVE CAP
092128	1	SPACER BUSH	622003	R 1	O-RING
092129	2	SPACER BUSH	622010	R 1	O-RING
092131	2	SAFETY BUSH	622015	R 1	O-RING
092138	1	SPACER	622024	R 5	O-RING
100012	1	MAGNET	622030	R 3	O-RING
104189.1	1	CPL CYLINDER P45C	622036	R 1	O-RING
122027	1	PULLEY	622046	R 1	O-RING
128084	1	COVER	622047	R 2	O-RING
138500	1	BODY	622052	R 1	O-RING
140166.1	1	CAP P45C	622102	R 1	O-RING
140242	1	CPL REMOTE	622130	R 1	O-RING
145194	1	BASIC SLIDER FN/FNDF /NT >	622139	R 1	O-RING
164091.1	1	CPL TRIGGER	622148	R 1	O-RING
166035	R 1	GASKET	622163	R 1	O-RING
168289	1	DRIVER PLATE FNDF 70	650007	R 9	NUT M3
172441	1	LOADER ASSEMBLY	650008	R 2	NUT M4
184002	1	CATCH	650017	R 4	NUT M6
200014	R 1	SPRING	660015	R 2	WASHER
200051	R 1	SPRING	662003	R 1	PIN
200160	R 1	SPRING	662019	R 3	PIN
200202	R 1	SPRING	662025	R 1	PIN
200207	R 1	SPRING	662067	R 2	PIN
200220	R 1	SPRING	666003	R 1	SCREW
200224	R 1	SPRING	666004	R 3	SCREW
280051.4	R 1	BUMPER	666043	R 2	SCREW
288129	1	PIN	666044	R 5	SCREW
288218	1	PIN CT/SS	666051	R 4	SCREW
288232	1	CPL PIN	667003	R 4	SCREW
288272	1	PIN	667015	R 1	SCREW
288274	1	PIN	667020	R 1	SCREW
288275	1	PIN	667031	R 3	SCREW
288297	1	PIN	668043	R 1	SCREW
288304	1	CPL STUD	676002	1	BALL 5/32
300586.2	1	CPL VALVE PISTON			
300620.3	R 1	CPL DRIVER PISTON			
326041.2	1	CPL ADAPTER 3/8 19 THREAD			
340079.1	1	LIMITING INSERT			
340084	1	INSERT			
340093	1	LIMITING INSERT FNDF			
348012	1	STOP RING			

R = RECOMMENDED SPARE PARTS  
> = DENOTES NEW CHANGE