

ESP	MACHINE CODE	
6	A10647	
DESC.	F5 SQ-65	
CPL BODY	138554	

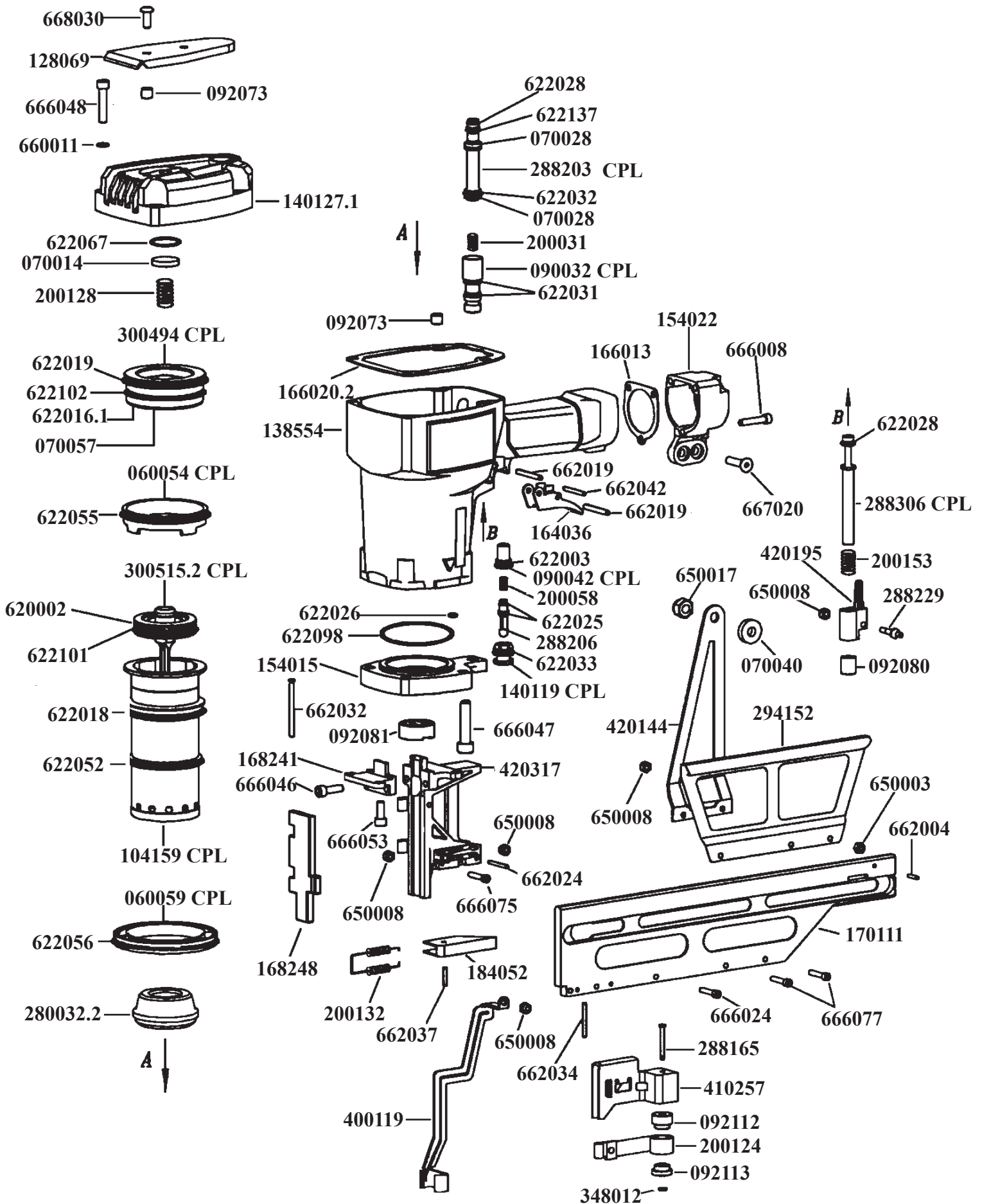

MACHINE CODE
A10647

MODEL
F5 SQ - 65

PARTS LIST

CODE	QTY	DESCRIPTION	CODE	QTY	DESCRIPTION
060054	1	CPL VALVE RING	400119	R 1	SAFETY
060059	1	CPL CYLINDER RING	> 410257	R 1	PUSHER
070014	R 1	BUFFER	420144	1	HOLDER
070028	R 2	BUFFER	420195	1	ACTUATOR
070040	R 1	BUFFER	420317	1	NOSE PIECE
070057	R 1	BUFFER	620002	R 1	O-RING
090032	1	CPL VALVE BUSH	622003	R 1	O-RING
090042	1	CPL BUSH	622016.1	R 1	O-RING
092073	4	BUSH	> 622018	R 1	O-RING
092080	1	BUSH	622019	R 1	O-RING
092081	1	BUSH	622025	R 2	O-RING
092112	1	BUSH	622026	R 1	O-RING
092113	1	BUSH	622028	R 2	O-RING
104159	1	CPL CYLINDER	622031	R 2	O-RING
128069	1	EXHAUST DEFLECTOR	622032	R 1	O-RING
138554	1	BODY	622033	R 1	O-RING
140119	1	CPL REMOTE CONTROL	> 622052	R 1	O-RING
140127.1	1	CPL CAP	622055	R 1	O-RING
154015	1	MODULAR ADAPTER	622056	R 1	O-RING
154022	1	ADAPTER	622067	R 1	O-RING
164036	1	CPL TRIGGER	622098	R 1	O-RING
166013	R 1	GASKET	622101	R 1	O-RING
166020.2	R 1	GASKET	622102	R 1	O-RING
168241	1	PLATE	622137	R 1	O-RING
168248	1	PLATE	650003	R 3	NUT
170111	1	RAIL	650008	R 7	LOW SELF LOCK NUT
184052	1	CATCH	650017	R 1	LOW SELF LOCK NUT
200031	R 1	SPRING	660011	R 4	WASHER
200058	R 1	SPRING	662004	R 1	PIN
200124	R 1	SPRING	662019	R 2	ELAST SPIRAL HEAVY PIN
200128	R 1	SPRING	662024	R 2	PIN
200132	R 1	SPRING	662032	R 1	PIN
200153	R 1	SPRING	662034	R 1	PIN
280032.2	R 1	BUMPER	662037	R 1	PIN
288165	1	PIN	662042	R 1	PIN 3X26
288203	1	CPL STUD	666008	R 3	SCREW TCEI UNC 10-24X1-1/2
288206	1	STUD	666024	R 1	SCREW
288229	1	PIN	666046	R 2	SCREW
288306	1	CPL PIN	666047	R 4	SCREW
294152	1	PLATE	666048	R 4	SCREW
300494	R 1	CPL VALVE PISTON	666053	R 4	SCREW
300515.2	R 1	CPL DRIVER PISTON	> 666077	R 2	SCREW
348012	1	SPACER	667020	R 1	SCREW
			668030	R 2	SCREW

R = RECOMMENDED SPARE PARTS

> = DENOTES NEW CHANGE