

ESP	MACHINE CODE	DESC.
5	A10198	P21P 4000-25

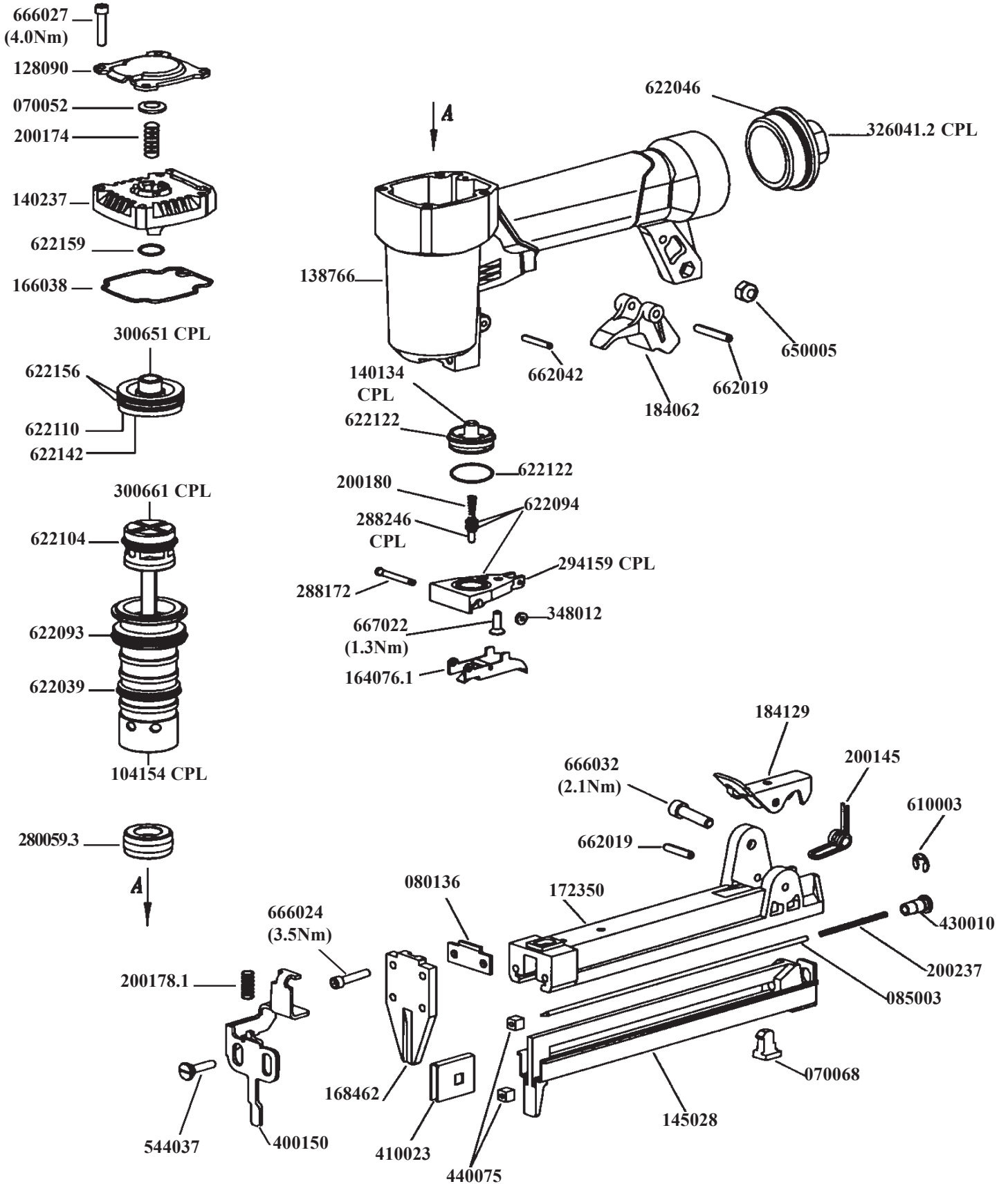

MACHINE CODE
A10198

MODEL
P21P 4000-25

PARTS LIST

CODE	QTY	DESCRIPTION	CODE	QTY	DESCRIPTION
070052	R 1	BUFFER	650005	R 1	LOW SELF LOCKING NUT
> 070068	R 1	BUFFER	662019	R 2	Elast Spir Heavy Pin 4x36
080136	1	DRIVER REST	662042	R 1	PIN
085003	1	BAR	666024	R 2	SCREW TCEI M4x18C12.9
104154	1	CPL CYLINDER	666027	R 4	SCREW TCEI M4x25C12.9
128090	1	COVER	666032	R 1	SCREW TCEI M4x14 C
138766	1	BODY	667022	R 1	SCREW TSEI M4x12 c10.9
140134	1	CPL VALVE			
140237	1	CPL Cap			
145028	1	SLIDER			
164076.1	1	CPL TRIGGER			
166038	R 1	GASKET			
168462	1	DRIVER PLATE			
172350	1	LOADER			
184062	1	QUICK RELEASE CATCH			
> 184129	1	CATCH			
200145	R 1	SPRING			
200174	R 1	SPRING			
200178.1	R 1	SPRING			
200180	R 1	SPRING			
> 200237	R 1	SPRING			
> 280059.3	R 1	BUMPER			
288172	1	PIN			
288246	1	CPL STUD			
294159	R 1	CPL PLATE			
300651	1	CPL VALVE PISTON			
300661	R 1	CPL DRIVER PISTON			
> 326041.2	1	ADAPTER			
348012	1	STOP RING			
400150	R 1	SAFETY			
410023	R 1	PUSHER			
430010	1	BAR RETAINER			
440075	2	PUSHER BLOCK			
544037	R 2	SCREW			
610003	R 1	STOP RING			
622039	R 1	O-RING			
622046	R 1	O-RING			
622093	R 1	O-RING			
622094	R 3	O-RING			
622104	R 1	O-RING			
622110	R 1	O-RING			
622122	R 2	O-RING			
622142	R 1	O-RING			
622156	R 2	O-RING			
622159	R 1	O-RING			

R = RECOMMENDED SPARE PARTS
> = DENOTES NEW CHANGE